

Catalogue number: **GMC-□M-□□**



CONTACTOR MINI: 3P AC or DC COIL 1 Auxiliary Contact



Mini Contactor 3 pole 1N/C or 1N/O AC or DC Coil

- DIN rail mountable for easy installation
- Compact size with 45mm width to save on enclosure size
- Available in AC and DC control coil voltages
- Screw clamp type terminals

Generic photo only (actual product may change depending on configuration)

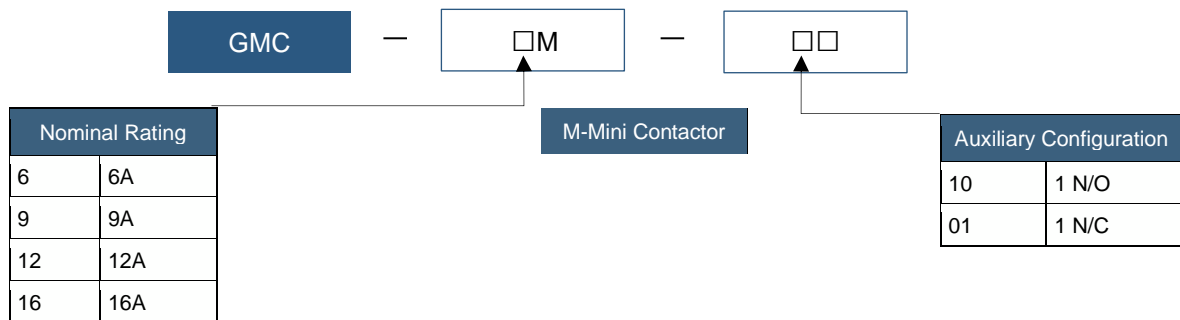

Frame size	AC3 RATINGS				AC1 rating	Auxiliary contact (standard)	GMC Type
	220 ~240V	380 ~440V	500 ~550V	690V			
6A	1.5kW 7A	1.5kW 7A	1.5kW 7A	1.5kW 7A	20A	1NO 1NC	GMC-6M-01 GMC-6M-10
9A	2.2kW 9A	2.2kW 9A	2.2kW 9A	2.2kW 9A	20A	1NO 1NC	GMC-9M-01 GMC-9M-10
12A	3kW 12A	3kW 12A	3kW 12A	3kW 12A	20A	1NO 1NC	GMC-12M-01 GMC-12M-10
16A	4Kw 15A	4Kw 15A	4Kw 15A	4Kw 15A	20A	1NO 1NC	GMC-16M-01 GMC-16M-10

*Coil Voltages available as follows: 24VAC, 32VAC, 110VAC, 240VAC, 415VAC.



Catalogue number: **GMC-□M-□□**



CONTACTOR MINI: 3P AC or DC COIL 1 Auxiliary Contact

Specifications	
Manufacturer	LS Electric
Product range	Contactors
Application	Mini Contactors for Motors and Reversing Loads
Ie, Rated Operational Current, AC-1, 415V, 40°C	20 A@415V,40°C
Ie, Rated Operational Current, AC-3, 690V	5 A@690V
Number of Poles	3
Contact Configuration, Main Poles	3 NO main poles
Contact Configuration, Auxiliary	1 NC or NC auxiliary depending on (10 or 01)
Coil Voltage	24VAC, 32VAC, 110VAC, 240VAC, 415VAC, 24VDC
IP Rating	IP 20
Electrical Endurance	1 mil. operations
Mechanical Endurance	12 mil. operations
Coil consumption	2 W
Inrush	32VA
Sealed	6VA
Closing voltage (%)	80~110
Opening voltage (%)	30~40
Closing time (ms)	10~20 ms
Opening time	35~45
Reference Standards	IEC 60947-4

Circuit diagram

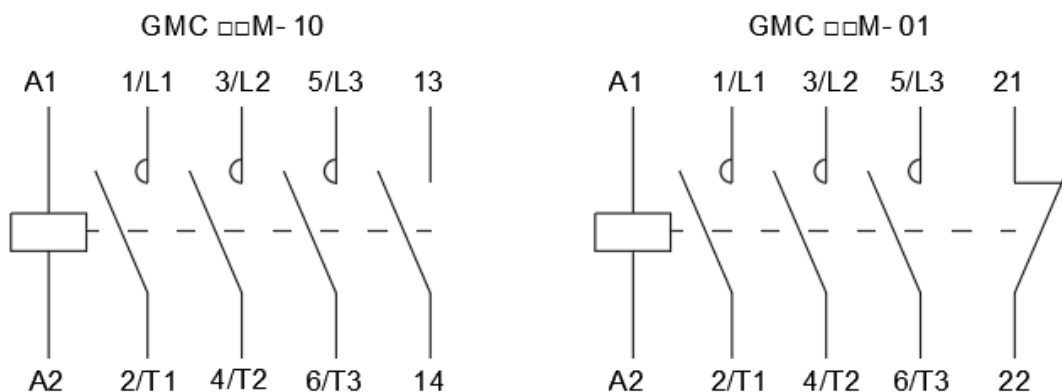

Catalogue number: GMC-□M-□□

CONTACTOR MINI: 3P AC or DC COIL 1 Auxiliary Contact



Mini contactors with Screw clamp type

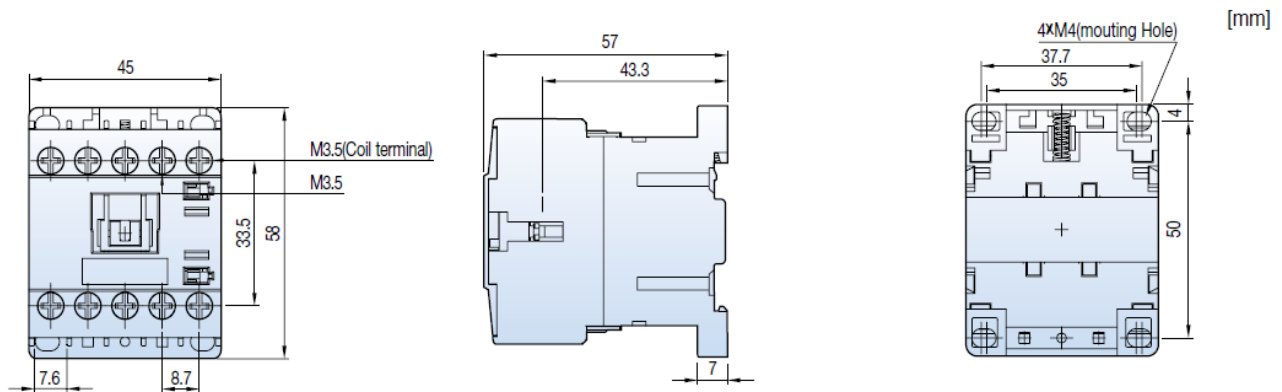

0.17kg

 Caution

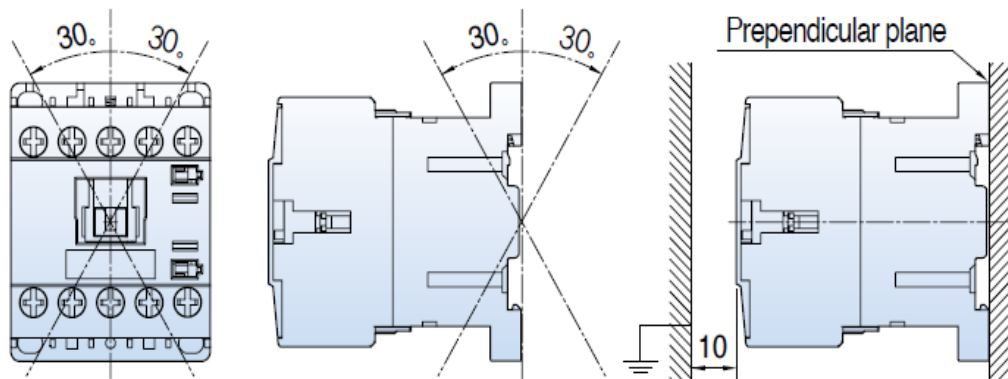

(Fig.1)

(Fig.2)

Installing directions of Fig.1 needs to be followed.
Distance of 10mm or more to be kept with arc space as shown in Fig 2.